

LOWER GRATE WITH 25 Holes

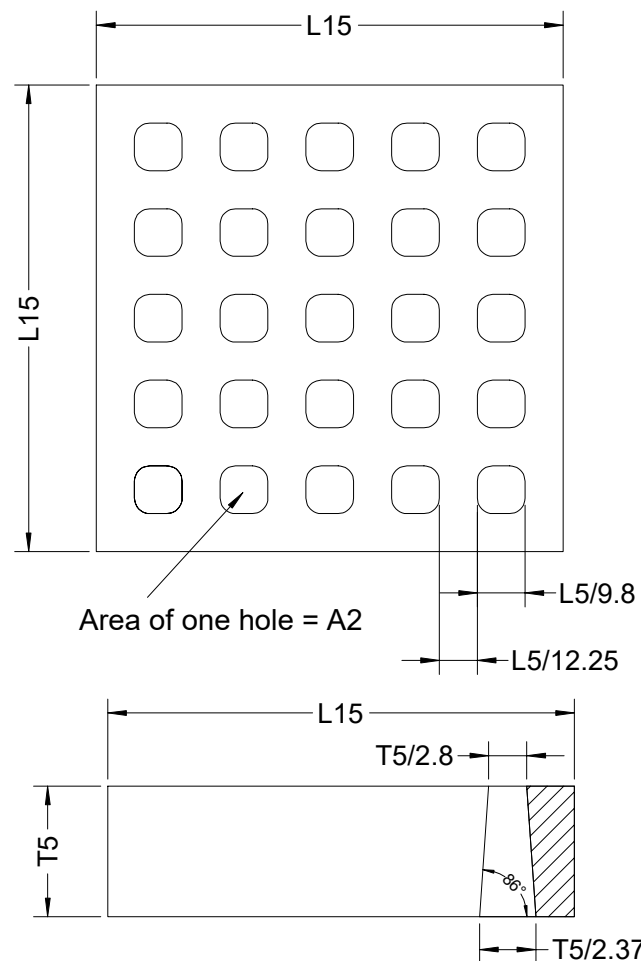

For use with Table of Dimensions for Ugandan Simba Stove 50 to 1000 litres			UG Simba Institutional Stoves	
			Features: Castable refractory cement square vibrated fired to Cone 6 clears the recess by 2.5mm on each side	
			Material:	Castable Refractory Cement
			Quantity:	1 per stove
			Scale:	Not to scale
Version:	1.0	Date:	2024-01-20	Initials CPP
Drawing No. UG-Simba-20 Grate with 5 rows			Part	Grate